

PLAN OF S.U.G.W.R. FOR DOMESTIC CAPACITY- 1200 GALLON  
SCALE - 1: 50

DEPTH OF SEPTIC TANK & U.G. W. RESEV. SHOULD NOT EXCEEDS THE DEPTH OF BUILDING FOUNDATION

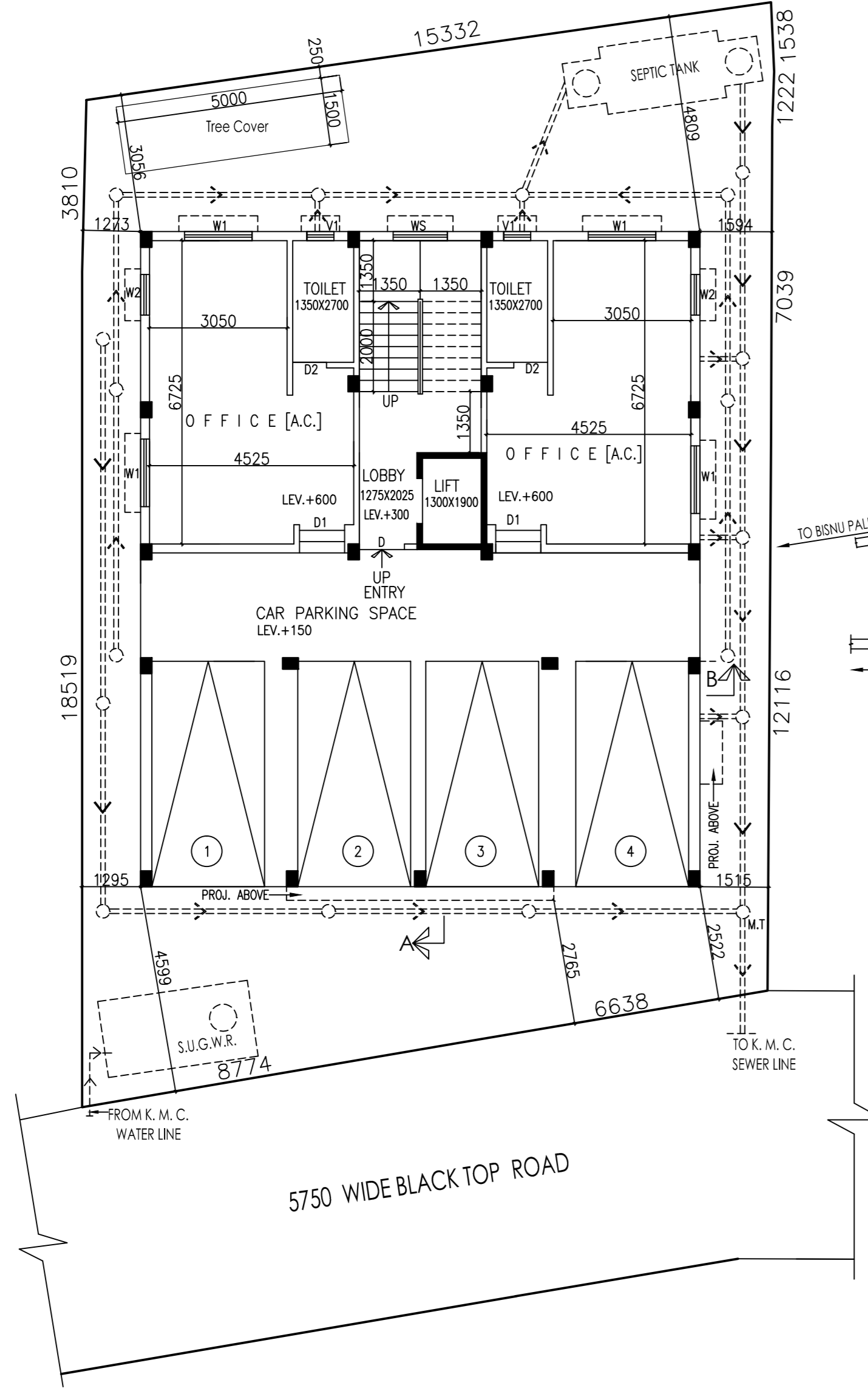

GROUND FLOOR PLAN  
SCALE 1:100

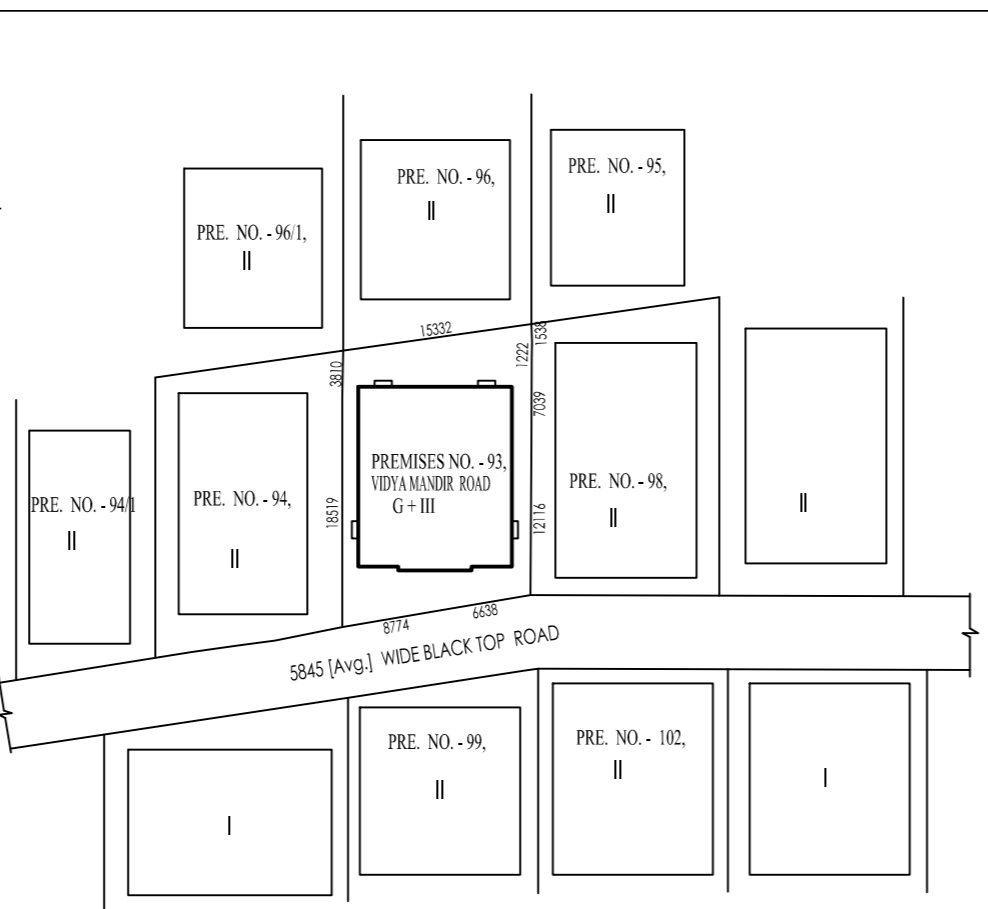

SITE PLAN  
SCALE = 1:600

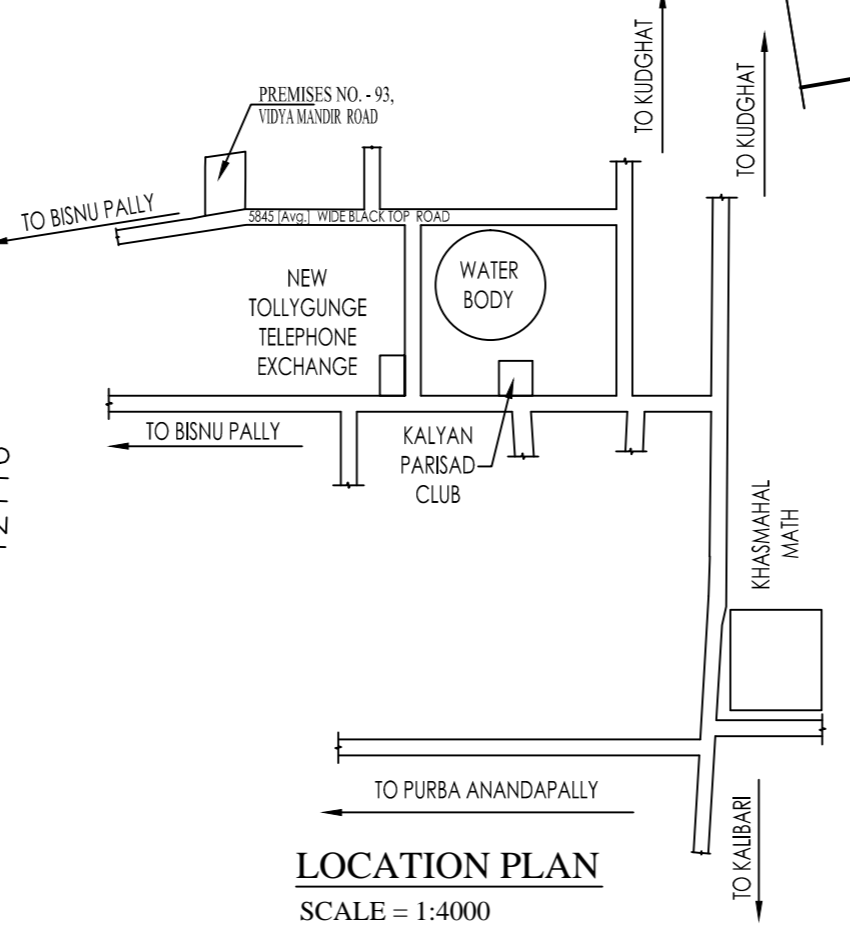

LOCATION PLAN  
SCALE = 1:4000

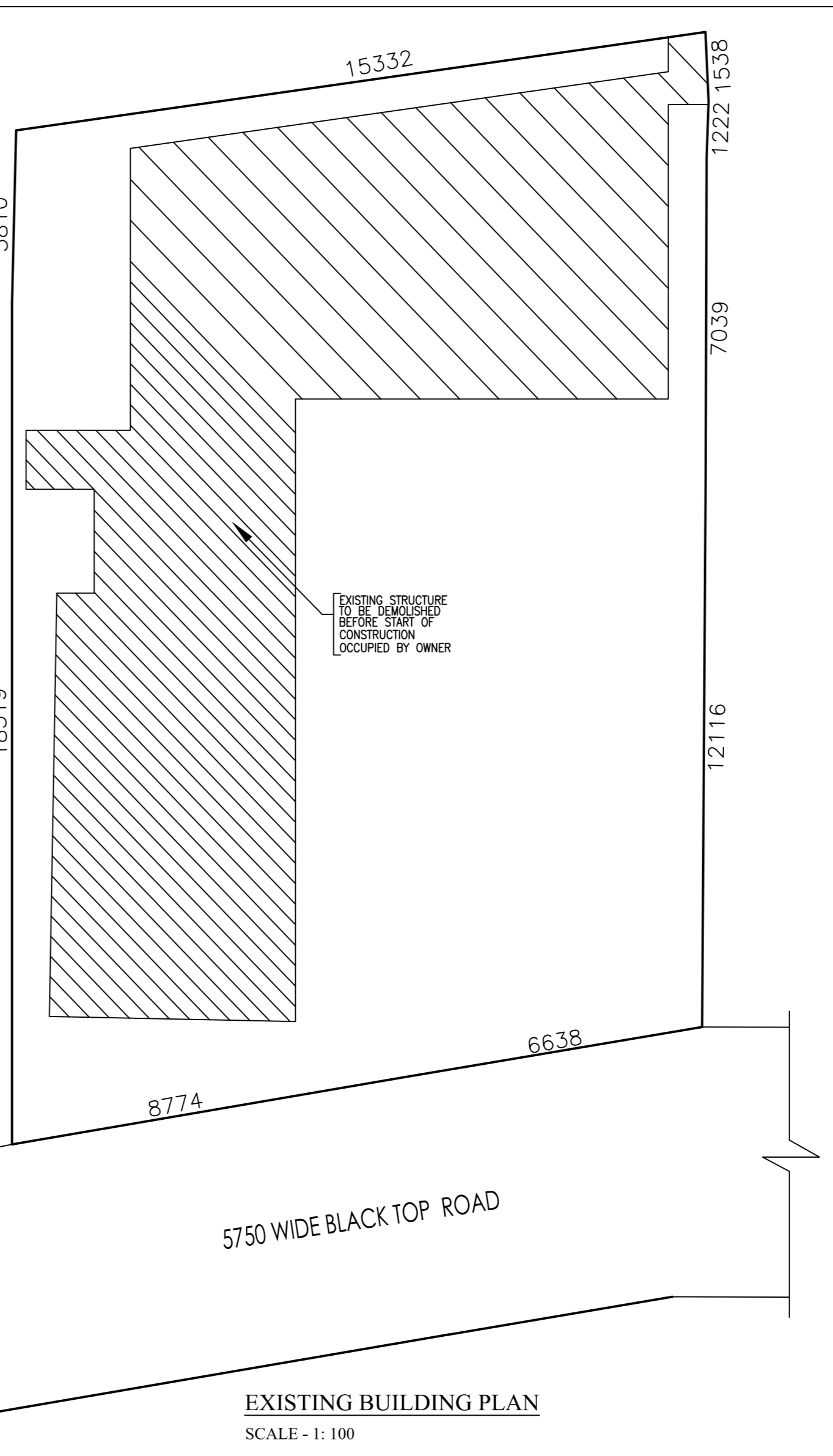

EXISTING BUILDING PLAN  
SCALE - 1: 100

**CERTIFICATE**  
PREMISES NO. - 93, VIDYA MANDIR ROAD, WARD NO. - 114,  
Permissible Height in reference co CCZM issued by AAI : 33.0 M.  
Co-Ordinate in WGS 84 and site elevation (AMSL)

Reference points marked in the site plan of the proposal	Co-ordinate in WGS 84		Site Elevation (AMSL)
	Latitude	Longitude	
A	22°9'78624" N	87°74'7803" E	8.00 M.

The above information is true and correct in all respect and if at any stage, it is found otherwise, then I shall be fully liable for which KMC and other appropriate authority reserve the right to take appropriate action against me as per law.

ANJAN KUMAR SARKAR  
SANJAY SARKAR  
SANJIB SARKAR  
NAME OF OWNER

KUSH KUNDU  
L. B. S. NO - 1 / 1412  
NAME OF L. B. S.

**SCHEDULE OF DOORS & WINDOWS**

NO	SILL	LINTEL	SIZE
D	-	2100	1000X2100
D1	-	2100	900X2100
D2	-	2100	750X2100
DW	-	2100	1400X2100
W1	900	2100	1500X1200
W2	900	2100	900X1200
WK	1050	2100	1000X1050
V	1500	2100	600X600
WS	900	2100	1200X1200

**TITLE-**  
GROUND FLOOR PLAN, SITE PLAN, LOCATION PLAN, SEPTIC TANK AND S.U.G.W. R.  
FOR OFFICE USE  
BUILDING PERMIT NO. - 2025110012  
SANCTION DATE - 12.04.2025  
VALID UPTO - 11.04.2030

- NOTES AND SPECIFICATION**
- ALL DIMENSIONS ARE IN MM.
  - THK. OF ALL OUTER WALLS ARE 250 MM WITH 1:6 CEMENT SAND MORTAR.
  - THK. OF ALL INNER WALLS ARE 125 MM WITH 1:4 CEMENT.
  - WIDTH OF THE CHAJJA 400 MM.
  - 19 MM THK. PLASTERING TO OUTER WALLS AND 12 MM THK. TO INNER WALLS & 6 MM THK. TO CEILING.
  - DEPTH OF S.U.G.W.R SHOULD NOT EXCEED MORE THAN DEPTH OF COL. FOUNDATION.
  - GRADE OF CONCRETE M-20, GRADE OF STEEL FE-500.

DIGITAL SIGNATURE OF ASSISTANT ENGINEER(C)/BLDG./BR-XI

DIGITAL SIGNATURE OF EXECUTIVE ENGINEER(C)/BLDG./BR-XI

**STATEMENT OF THE PLAN PROPOSAL.**

A.	B.
1. Assessee NO. - 31-114-26-0093-0	1. A) Area of land :- 336.771 Sqm. = 5 K. 00 CH. 25 SFT [ As per Deed ] b) Area of land :- 337.104 Sqm. = 5 K. 00 CH. 28.59 SFT [ As per Physical ]
2. Details of Deed Of Transfer - Book No. - I, Volume No. - 1603-2024, Page - 14839 TO 14862, Being No - 160300492, Date - 15.01.2024, At D.S.R. - III, SOUTH 24 - PARGANAS	2. Ground Coverage a) Permissible:- 186.70 Sqm. [ 55.44 % ] b) Proposed :- 181.89 Sqm. [ 54.00 % ]
3. Details of Deed Of Gift - Book No. - I, Volume No. - 1603-2024, Page - 54022 TO 54043, Being No - 160302074, Date - 09.02.2024, At D.S.R. - III, SOUTH 24 - PARGANAS	3. F. A. R. :- a) Permissible :- 1.75 (b) Proposed :- 1.679
4. Details of Boundary Declaration :- Book No. - I, Volume No. - 1602 TO 2024, Page - 441679 TO 441690, Being No - 160213252, Date - 20.09.2024, At D. S. R. - II, South 24-Pgs.	4. Total covered area :- a) Permissible :- 589.349 Sqm b) Proposed :- i] 718.37 Sqm. (Including exempted area) ii] 657.286 Sqm. (Excluding exempted area) iii] 61.084 Sqm. (Exempted area)

**AREA STATEMENT**

Area Of The Land :- 05 K. 00 CH.-25 SFT = 336.771 SQM. [ As Per Deed ]  
Area Of The Land :- 05 K. 00 CH.-28.59 SFT = 337.104 SQM. [ As Per Physical ]  
Permissible Ground Coverage :- 186.70 Sqm. [ 55.44 % ]  
Proposed Ground Coverage :- 181.888 Sqm. [ 54.00 % ]

Floor	Gross Floor Area	Less For Lift Well	Actual Floor Area	Exempted Area Stairway	Net Floor Area
Gr. Floor	180.11	-	180.11	2.582	164.838
First Floor	181.888	2.470	179.418	2.582	164.146
Second Floor	181.888	2.470	179.418	2.582	164.146
Third Floor	181.888	2.470	179.418	2.582	164.146
Total Floor	725.774	7.41	718.364	50.76	657.276

Proposed F. A. R. :-  $\frac{657.276 - 91.76}{336.771} = 1.679$

No. Of Tenament :- 6 Nos.  
Size Of Tenament :-

Tenament Marked	Tenament Area In Sqm.	Proportional Common Area to be Added	Actual Tenament Area In Sqm.	Tenament Number
A	81.595	11.317	92.912	03
B	81.595	11.317	92.912	03

Area Of Office :-  
Covered :- 69.112 Sqm.  
Carpet :- 58.728 Sqm. ( 1 No Car Parking Required )  
Area of Car Parking:- 91.76 Sqm.  
Size Of Tenament :-  
75.0 Sqm. to 100.0 Sqm. - 6 Nos. (3 Nos Car Parking Required)

Area Of C. B. - 2.80 X 3 FLS = 8.40 Sqm.  
Area Of Stair Head Room - 15.680 Sqm.  
Area Of Lift Machine Room - 9.200 Sqm.  
Area Of Lift Machine Stair - 3.650 Sqm.  
Area Of O. H. W. R. - 11.360 Sqm.  
Permissible Tree Cover Area ( 1.796 % ) = 6.05 Sqm.  
Proposed Tree Cover Area ( 2.23 % ) = 7.50 Sqm.

Total No. of car parking - Required - 4 nos. Provided - 4 nos.

- NOTES AND SPECIFICATION**
- Thk. of all outer walls are 200 mm with 1:6 cement sand mortar.
  - Thk. of all inner walls are 125 mm with 1:4 cement and sand mortar.
  - Width of the chajja 450 mm.
  - 19 mm thk. plastering to outer walls and 12 mm thk. to inner walls & 6 mm Thk. to ceiling.
  - 19 mm thk. plastering to outer walls and 12 mm thk. to inner walls & 6 mm Thk. to ceiling.
  - Grade of concrete M-20, Grade of steel Fe-500.
  - All dimension are in mm.

I do certify with full responsibility that the building plan has been drawn as per provision of K.M.C building rules 2009, as amended from time to time and the site condition including width of the abutting black top roads conforming with the site and it is a buildable site not a tank or filled up tank. It is bounded by boundary wall.

KUSH KUNDU  
L. B. S. NO - 1 / 1412  
NAME OF THE L. B. S.

The structural design and drawing of the both foundation and super structure of the building have been made by me considering all the possible loads including seismic load as per the National Building code of India latest revision and certify that it is safe and stable in all respect.

SUBHRA DAS  
E. S. E. NO - 8 / 588  
NAME OF THE E. S. E.

Undersigned has inspected the site & carried out the soil investigation therein. It is certified that existing soil of the site is able to carry out the load from the proposed construction and the foundation system therein is safe & stable in all respect from Geo - Technical point of view.

BHASKAR JYOTI ROY  
G. T. E. NO - 1 / 50  
NAME OF THE G. T. E.

We do hereby undertake with full responsibility that-  
1) We shall engage L.B.S & E.S.E during Construction.  
2) We shall follow the instruction of L.B.S & E.S.E during Construction of the building (As per B.S.plan)  
3) K. M. C. authority will not be responsible for Structural Stability of the building & adjoining structure.  
4) If any submitted documents are found to be fake, the K. M. C. authority will revoke the sanction plan.  
5) The construction of water reservoir and septic tank will be under the guidance of L. B. S. / E. S. E.  
6) During site inspection we were physically present and identified the plot on which plan proposal submitted.

ANJAN KUMAR SARKAR  
SANJAY SARKAR  
SANJIB SARKAR  
NAME OF THE OWNER

**PLAN PROPOSAL OF G + THREE STORIED RESIDENTIAL BUILDING AT PREMISES NO - 93, VIDYA MANDIR ROAD, WARD NO - 114, BOROUGH - XI. P. S. - REGENT PARK, KOLKATA - 700093, U/S 393 A OF K. M. C. ACT 1980 UNDER BUILDING RULES 2009 COMPLYING CIR. NO - 02 OF 2020 - 2021, DATED - 13/06/2020.**